

IMPORTANT SAFETY NOTICE

Information about Free Bypass Insert for 5-Gallon and Larger RIDGID® Wet/Dry Vacs

Why a Bypass Insert?

The Bypass Insert is a small, plastic ring that fits inside the inlet to the blower housing. When installed, it will reduce the **risk of motor damage, overheating, melted plastic, sparks, smoke, and/or fire** that may result from improper use of the Vac, including operating the Vac with the float in the raised position. The bypass insert will also limit the introduction of certain debris into the blower housing if the Vac is improperly used without a filter when vacuuming dry material.

How to obtain a Bypass Insert?

To request a Bypass Insert, simply visit us at www.emerson-toolcompany.com/bypass or call toll free **1-866-288-8143**

Please have your Model Number and Serial Number on hand (these may be found on a silver label on the back of the power head, by the handle, or by the blowing port).

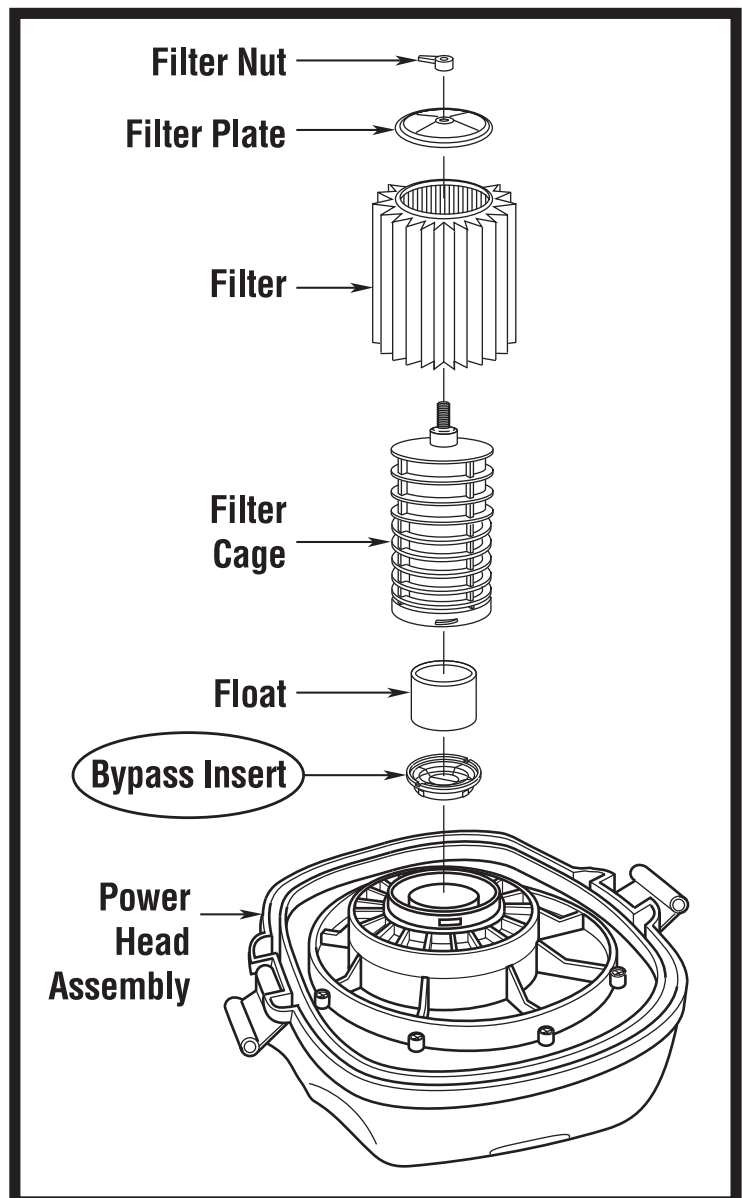

Please find your applicable model and serial number. In order to qualify, the vac must have BOTH a qualifying model number and qualifying serial number. A qualifying model number with a non-qualifying serial number and a qualifying serial number with a non-qualifying model number will not qualify.



Model Numbers:

Model Numbers that Qualify for Main Insert:

WD06000	WD12460	WD19500	WD1850M0	WD1630EX0	WD1250P0
WD06200	WD14500	WD20600	WD1851M0	WD1700EX0	WD1635P0
WD06250	WD16250	WD20620	WD0600EX0	WD1730EX0	WD1850P0
WD06350	WD16300	WD55000	WD0625EX0	WD1735EX0	WD1851P0
WD08000	WD16350	WD0625M0	WD0635EX0	WD1850EX0	WD1635EX0
WD09350	WD17000	WD0945M0	WD0945EX0	WD1851EX0	WD1735EX0
WD09450	WD17300	WD1245M0	WD1200EX0	WD0625P0	WD0600AR0
WD12000	WD17350	WD1635M0	WD1245EX0	WD0635P0	WD1200AR0
WD12300	WD17351	WD1735M0	WD1250EX0	WD0945P0	WD1630AR0
WD12450	WD18500	WD1735M1	WD1625EX0	WD1245P0	WD1730AR0

Model Numbers that Qualify for Detach Insert:

WD16500	WD16650	WD1660EX0	WD1665M0
WD16600	WD1650EX0	WD1665EX0	

Model Numbers That Do Not Qualify:

SG40000	WD45500
TV30000	WD24500
WD40500	

Serial Numbers (1st 2 Digits):

Serial Nos.that Qualify

98, 99, 00, 01, 02, 03, 04, 05, 06, 07

Serial Nos.that Do Not Qualify

08

All Other Serial Nos. (1st 2 Digits)

This serial number is not valid for this brand.